

SNDJ-D3*-G01 Series

Differential Hall-Effect Speed Sensors

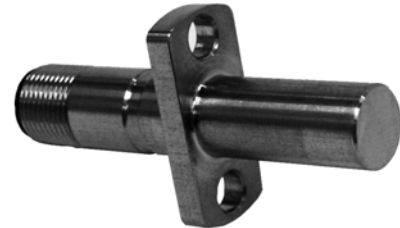

DESCRIPTION

The Hall-effect speed sensors are designed for use with a ferromagnetic gear or pole wheel to generate speed proportional impulse frequencies.

They exhibit dynamic function, whereby pulse generation down to 5 Hz is specified. The sensor must be oriented against the pole wheel as described in the orientation/mounting dimension drawings on page 3.

FEATURES

- Back biased differential hall sensor
- Direct sensing of ferrous metal target
- Rugged 12 mm [0.47 in] stainless steel housing
- IP68 sealing
- 2,0 mm [0.08 in] sensing range
- Preleaded cable of connector versions available

POTENTIAL APPLICATIONS

- High speed gear tooth sensing
- Over-speed detection
- Monitor shaft rotation
- Detect rotary position of gear or shaft

SNDJ-D3* -G01 Series

SENSOR SPECIFICATIONS

| Characteristic | Parameter |
|-----------------------|---|
| Supply voltage | 8 Vdc to 32 Vdc, protected against reverse polarity |
| Current consumption | 14 mA max. (without load) |
| Signal outputs | Square wave signal from push-pull stage, dc-coupled to the supply (negative pole = reference voltage) 30 mA max. load Output voltage HI: > power supply voltage 3.6 V (at I = 25 mA), 2.5 V (at I = 10 mA) Output voltage LO: < 2.2 V (at I = 25 mA), 1.4 V (at I = 10 mA) The output is short-circuit proof and protected against false polarity |
| Frequency range | 5 Hz to 25 kHz |
| Insulation | Housing, cable shield, and electronic galvanically isolated (500 V/50 Hz/1 min.) |
| Operating temperature | -20 °C to 100 °C [-4 °F to 212 °F] |
| Housing | Stainless steel 1.4305 |
| Cable/connector | P variant: with cable PUR, three wires 0.34 mm ² (AWG 22) C variant: with connector 4-pins/M12 standard |
| Protection class | Sensor head IP68, cable/entrance IP67, connector IP68 (mated) |
| Vibration immunity | 30 g in the range 5 Hz to 2000 Hz |
| Shock immunity | 50 g during 20 ms, half-sine wave |
| Weight | D3C-G01: ~40 g D30-G01: ~60 g, including 0,35 m cable |
| Air gap | For pole wheel M 0.5 (DP 50.8): 0,1 mm to 0,3 mm [0.004 in to 0.012 in] For pole wheel M1 (DP 25.4): 0,1 mm to 1,5 mm [0.004 in to 0.06 in] For pole wheel M2 (DP 12.7): 1,0 mm to 2,0 mm [0.04 in to 0.08 in] |
| Pole wheel | Ferromagnetic toothed wheel, i.e. B. USt37-2, preferred involute gear form Module ≥ 1 , min. tooth width 6 mm [0.24 in], side offset with min. tooth width: <0,2 mm [0.008 in], eccentricity <0,2 mm [0.008 in] |

NOTICE

INSTALLATION INFORMATION

- The sensor wires must be laid as far as possible from large electrical machines. They must not run parallel with power cables. The maximum permissible cable length is 20 m [65 ft].
- The sensor should be mounted with the middle of the face side over the middle of the pole wheel. Where the pole wheel has teeth or slots with radial sensor location, the sensor would normally be mounted over the center. Dependent upon the wheel width, a degree of axial movement is permissible.
- A solid and vibration-free mounting of the sensor is important.

Differential Hall-Effect Speed Sensors

ORIENTATION/MOUNTING DIMENSIONS (For reference only) mm [in]

D3C-G01

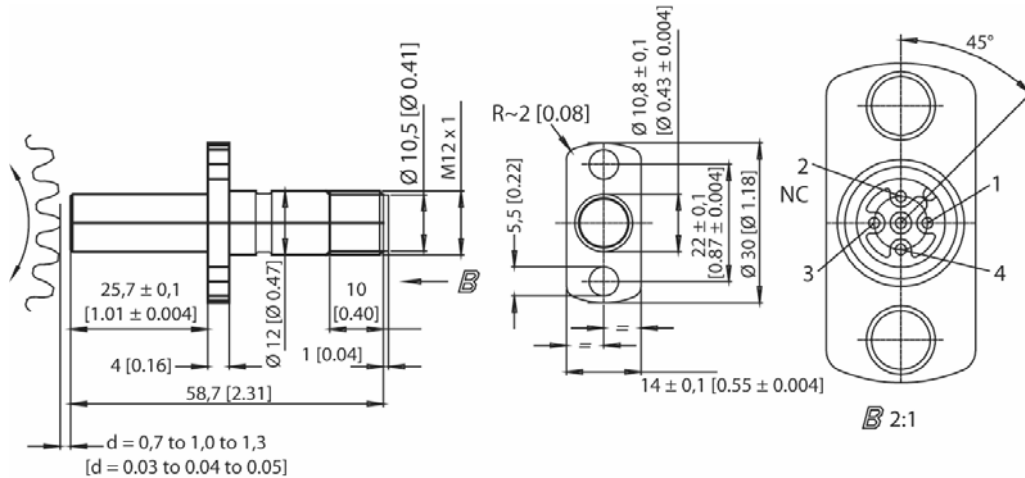

D3P-G01

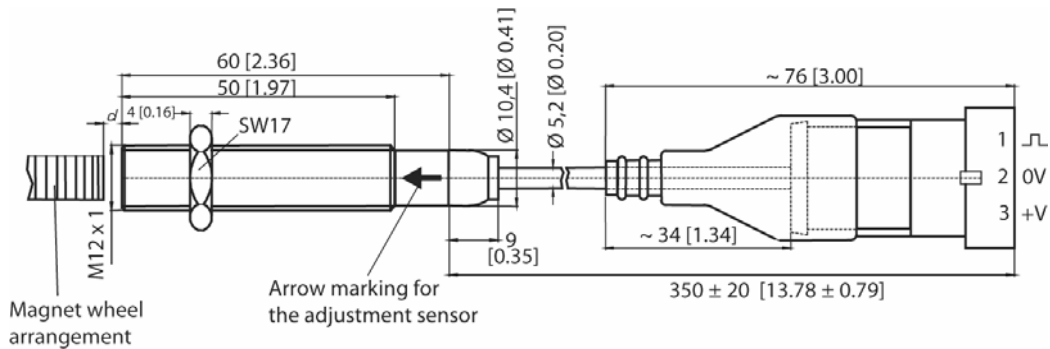

WIRING DIAGRAMS

D3C-G01

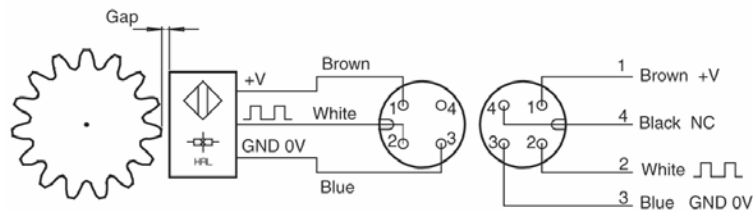

D3P-G01

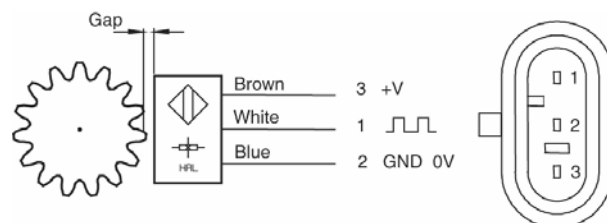

⚠ WARNING

PERSONAL INJURY

DO NOT USE these products as safety or emergency stop devices or in any other application where failure of the product could result in personal injury.

Failure to comply with these instructions could result in death or serious injury.

⚠ WARNING

MISUSE OF DOCUMENTATION

- The information presented in this product sheet is for reference only. Do not use this document as a product installation guide.
- Complete installation, operation, and maintenance information is provided in the instructions supplied with each product.

Failure to comply with these instructions could result in death or serious injury.

WARRANTY/REMEDY

Honeywell warrants goods of its manufacture as being free of defective materials and faulty workmanship. Honeywell's standard product warranty applies unless agreed to otherwise by Honeywell in writing; please refer to your order acknowledgement or consult your local sales office for specific warranty details. If warranted goods are returned to Honeywell during the period of coverage, Honeywell will repair or replace, at its option, without charge those items it finds defective. **The foregoing is buyer's sole remedy and is in lieu of all other warranties, expressed or implied, including those of merchantability and fitness for a particular purpose. In no event shall Honeywell be liable for consequential, special, or indirect damages.**

While we provide application assistance personally, through our literature and the Honeywell web site, it is up to the customer to determine the suitability of the product in the application.

Specifications may change without notice. The information we supply is believed to be accurate and reliable as of this printing. However, we assume no responsibility for its use.

SALES AND SERVICE

Honeywell serves its customers through a worldwide network of sales offices, representatives and distributors. For application assistance, current specifications, pricing or name of the nearest Authorized Distributor, contact your local sales office or:

E-mail: info.sc@honeywell.com

Internet: www.honeywell.com/sensing

Phone and Fax:

Asia Pacific +65 6355-2828
+65 6445-3033 Fax
Europe +44 (0) 1698 481481
+44 (0) 1698 481676 Fax
Latin America +1-305-805-8188
+1-305-883-8257 Fax
USA/Canada +1-800-537-6945
+1-815-235-6847
+1-815-235-6545 Fax

Automation and Control Solutions

Sensing and Control

Honeywell

1985 Douglas Drive North

Minneapolis, MN 55422

www.honeywell.com/sensing

005865-1-EN IL50 GLO Printed in USA
September 2006
© 2006 Honeywell International Inc. All rights reserved.

Honeywell